

# Bärenpark foam core insert



## Introduction

This insert is designed to speed the setup of Bärenpark for play. It stores the pieces in a setup for 4 players, so when setting the game up for 2 or 3 players, you'll need to adjust the stacks in the insert.

All foamcore in this plan is assumed to be 5mm foamcore. Alas, this means the game will sit slightly above the top of the box. This can be remedied with one piece of 3mm foamcore. To use this alternate build, note the alternate instructions for Tray E.

**NOTE:** The photos included here are examples of this build, but some nuances of the plans have been improved (based on lessons from this build.)

**Optional:** Cut a piece of foam in a 25W x 100L x 32H block

## Components to build

- 1 large Green Tiles tray
- 2 Flat Enclosures trays
- 2 long Bear Statue trays
- 1 bear statue and bonus tray
- 2 Animal House trays
- 1 Bonus card tray

## Credits

- *Bärenpark* is produced by Mayfair games.
- The format of this design was inspired by the generous folks over at PubMeeple.com.
- This foamcore build was designed by Brendan Riley and distributed by Rattlebox Games, and distributed *without explicit permission of Mayfair*. This design is distributed without warranty under a Creative Commons Attribution-NonCommercial-ShareAlike 4.0 International License.

## LARGE GREEN TILES TRAY (180W x 75L x 43H)

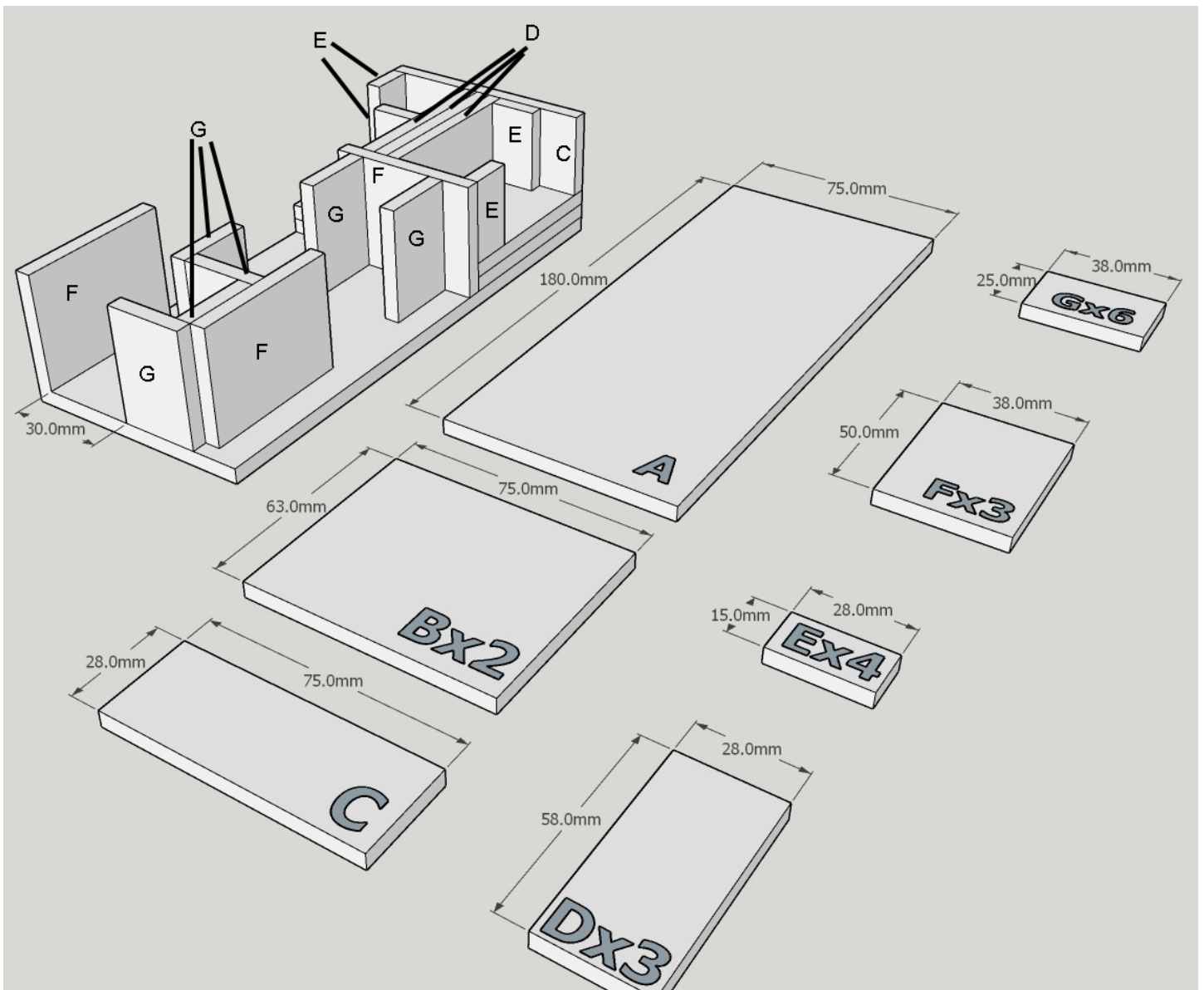

This tray holds the Green Tiles. While you could measure all these sections, we recommend using the tiles to fine-tune the measurements. Note that segment B is placed horizontally under the toilet and playground tiles.



## FLAT ENCLOSURE TRAY 1 (150W x 180L x 10H)

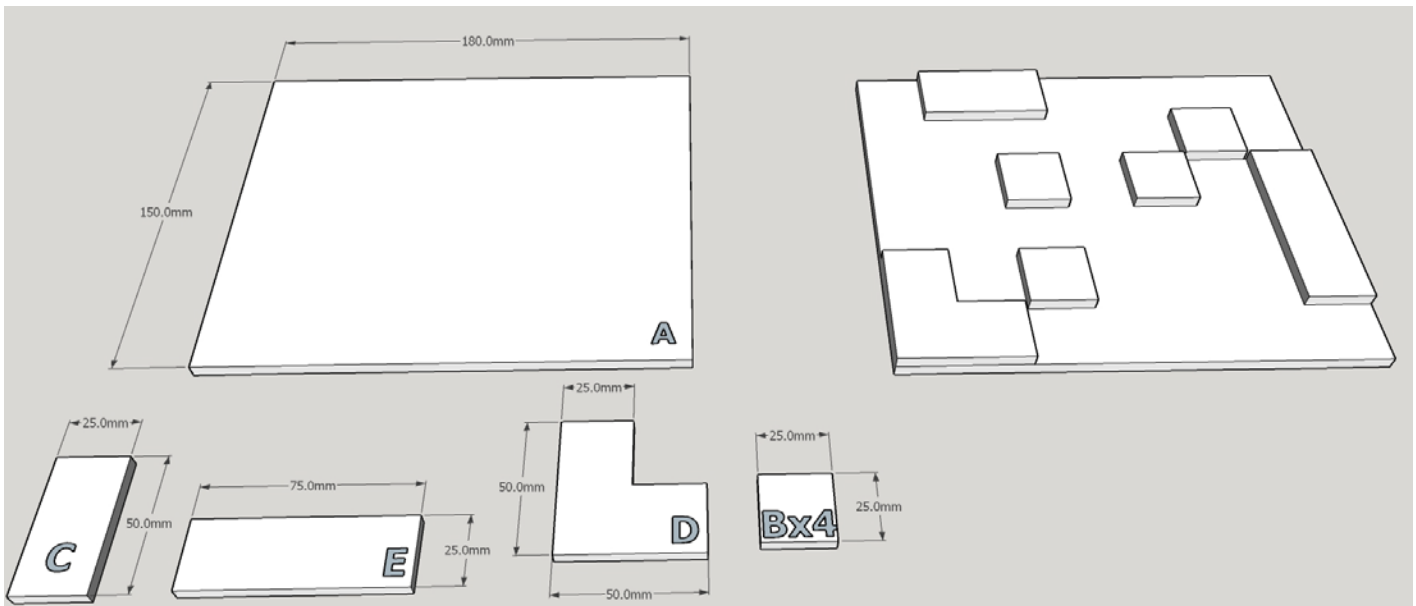

This tray holds the Polar Bear Enclosures and the Koala Enclosures, as shown. Again, if you cut the shapes and then use the tiles to put them in place, this will work better than trying to measure in the abstract.

I also used a pencil to draw each shape on the foamcore so that it's easier to put the shapes back afterward.

The ideal way to do it would be to print out the tiles and paste them on the foam core to make it easy to reload AND it would look nice.





## FLAT ENCLOSURE TRAY 2 (150W x 180L x 10H)



This tray holds the Gobi Bear Enclosures and the Panda Enclosures, as shown. Again, if you cut the shapes and then use the tiles to put them in place, this will work better than trying to measure in the abstract.

I also used a pencil to draw each shape on the foamcore so that it's easier to put the shapes back afterward.

The ideal way to do it would be to print out the tiles and paste them on the foam core to make it easy to reload AND it would look nice.



## 2 BEAR STATUE TRAYS (39W x 180L x 10H)

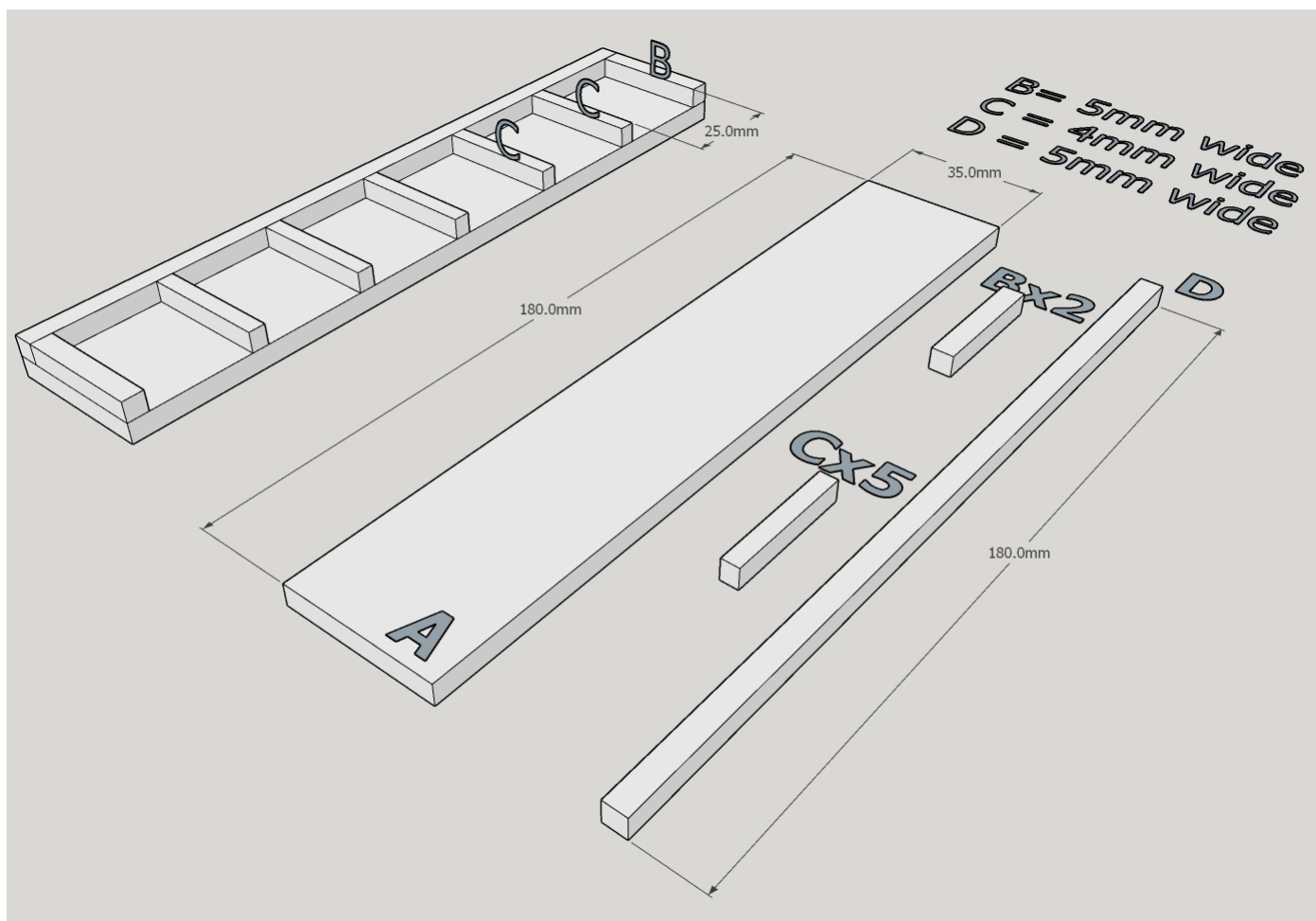

Make two identical trays to hold 12 of the 16 statues. Be sure to adjust the tokens available based on the player count.



## BEAR STATUE AND BONUS DISPLAY TRAY (75W x 180L x 10H)

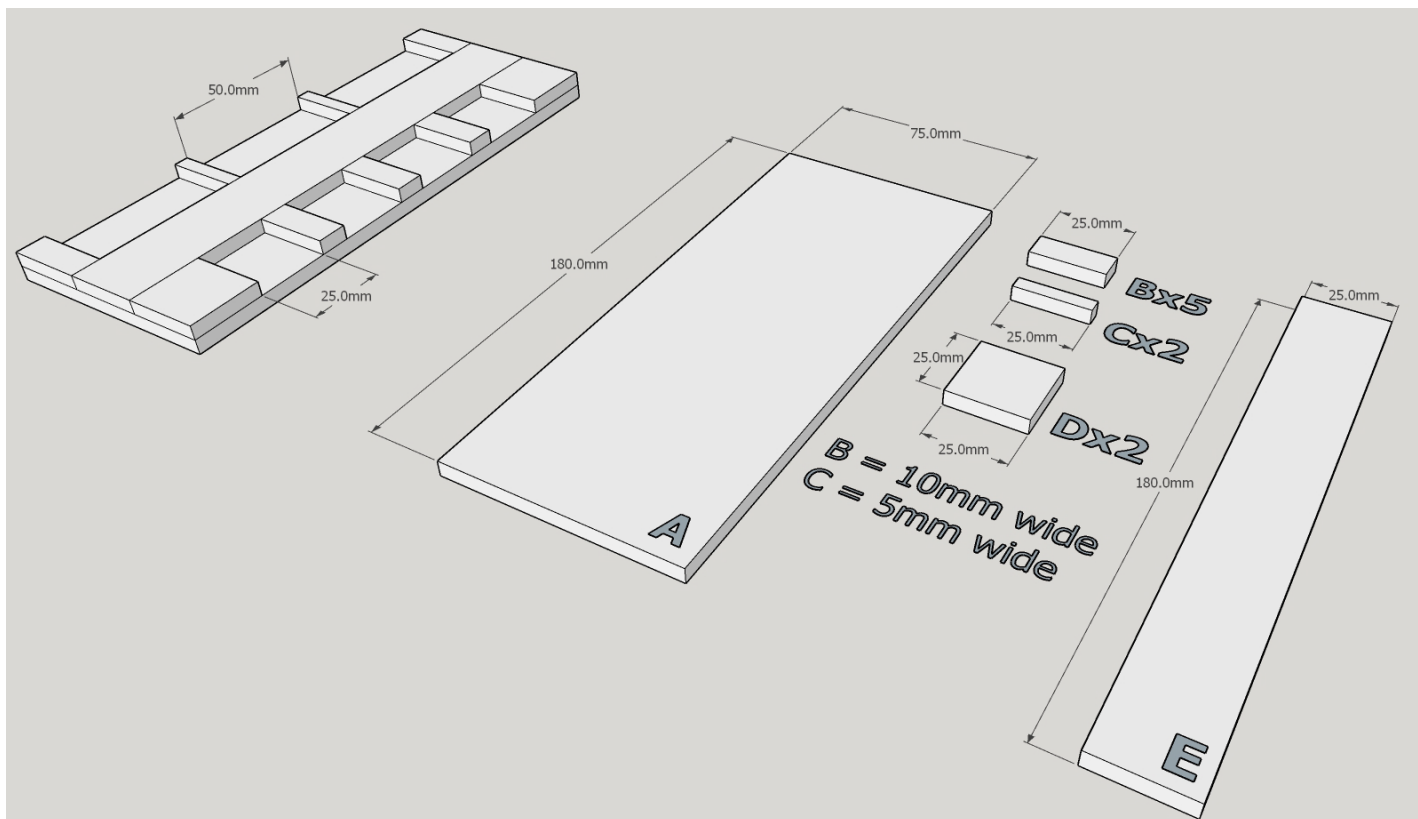

This tray displays the last four bear statues and provides a holding spot for the three sets of bonus tiles. (Note that the bonus tiles are stored in a different tray, but the three sets you pick to use for the game can be displayed on this tray.)

**NOTE:** The design for this tray changed slightly since I made the prototype, so the look of the photo example is slightly different than the look of the version built from the plans.





**ANIMAL HOUSE TRAY 1 (78W x 188L x 19H) or ALT (78W x 188L x 17H)**

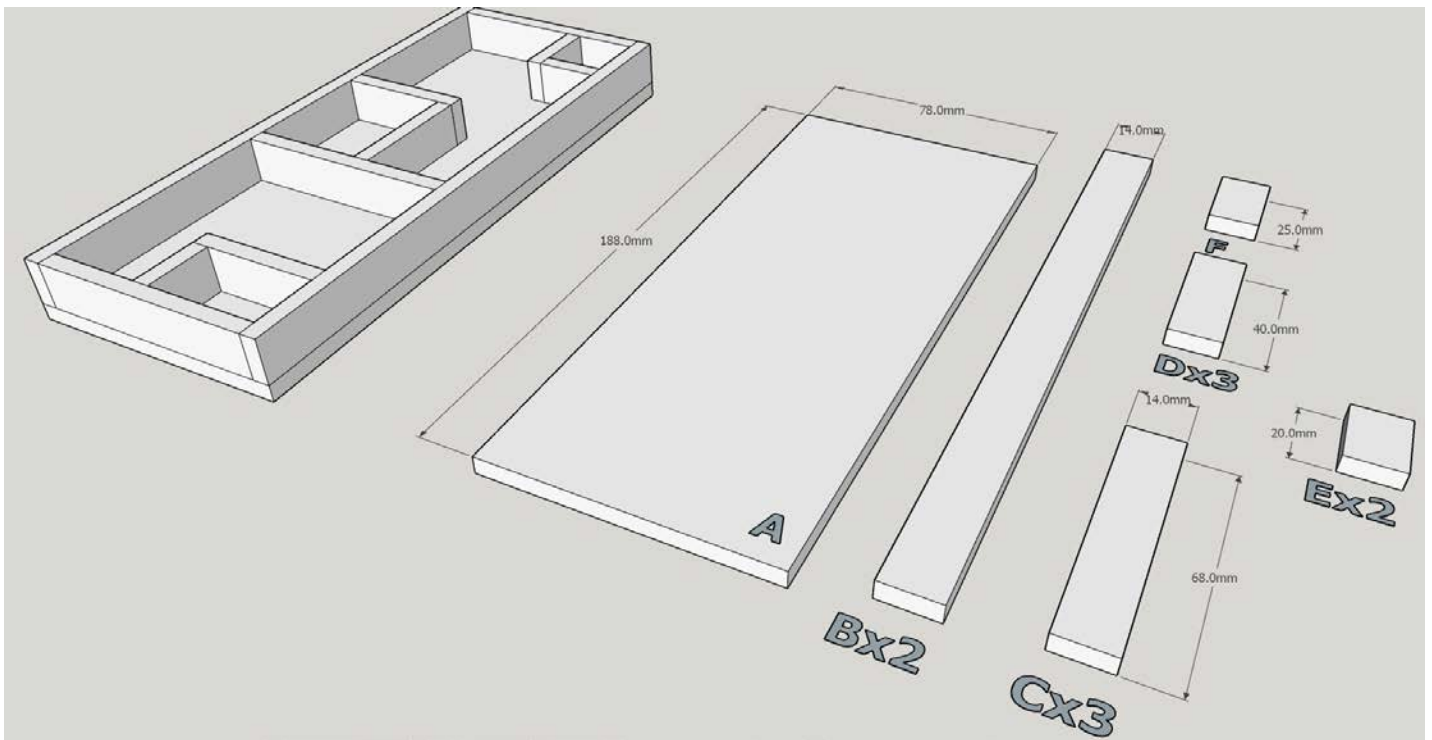

This tray holds the Panda and Polar Bear Animal Houses, as shown.

ALT OPTION: If you have 3mm foam core, use 3mm instead of 5mm for segment A. This will reduce, slightly, the height of the stack and even out the board on the top of the game.



**ANIMAL HOUSE TRAY 2 (78W x 188L x 19H) or ALT (78W x 188L x 17H)**

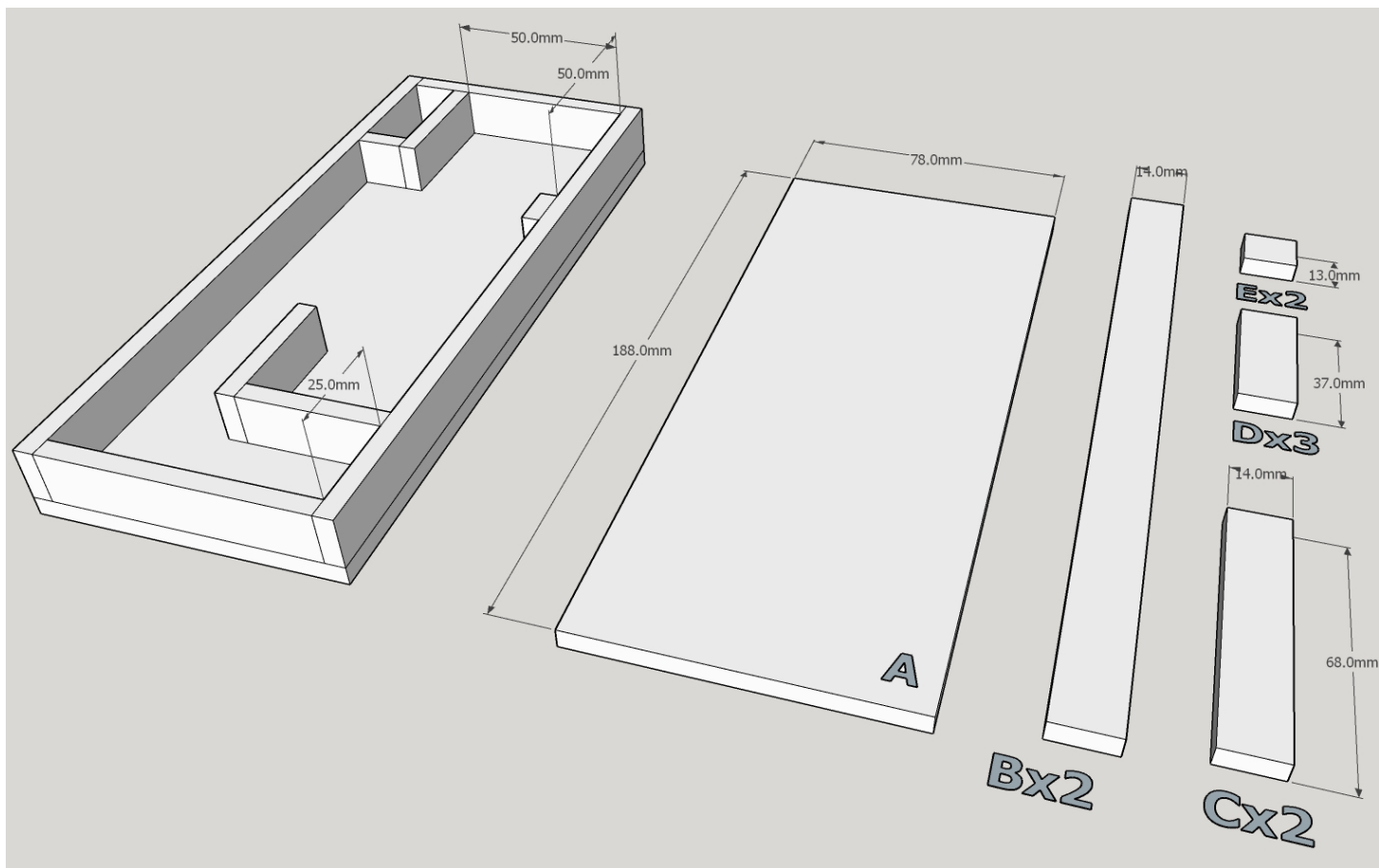

This tray holds the Gobi Bear and Koala Houses, as shown.

ALT OPTION: If you have 3mm foam core, use 3mm instead of 5mm for segment A. This will reduce, slightly, the height of the stack and even out the board on the top of the game.





**BONUS CARD TRAY (64W x 100L x 43H) \*ALT Available**

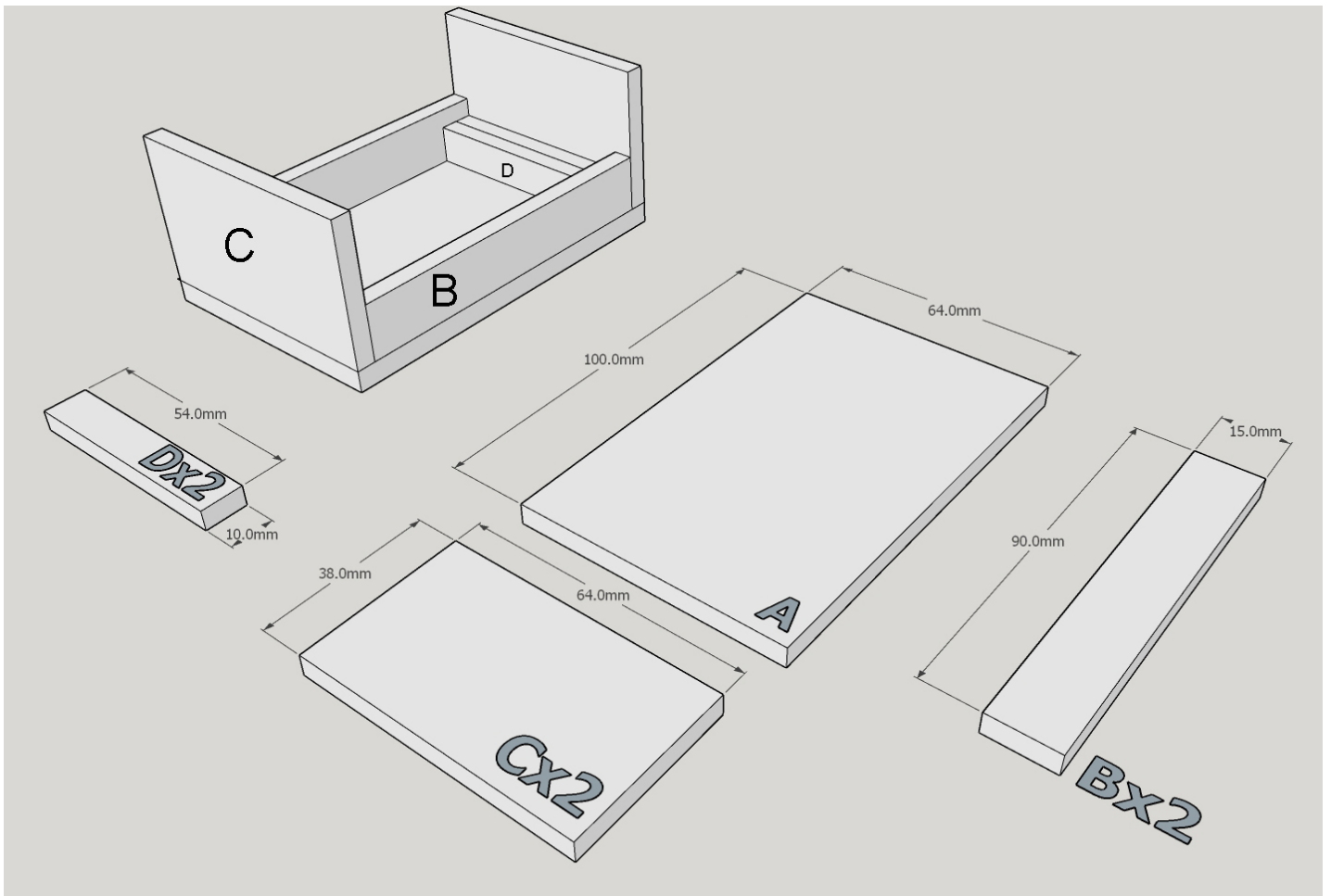

This tray holds the Bonus cards.

**ALT OPTION:** If you have 3mm foam core, use 3mm instead of 5mm for segment A. Adjust the height of part C to 40mm. This will keep the overall height of the box at 43mm, but will make the Bonus tiles sit a bit lower in the box.

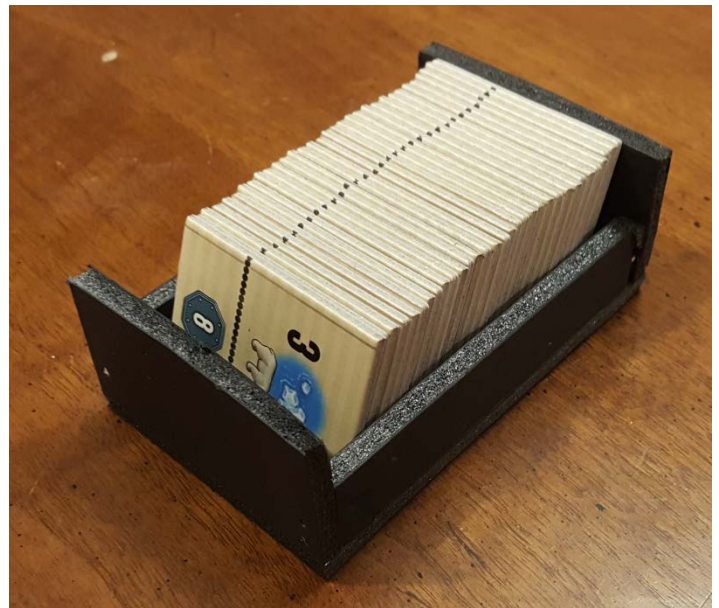

## PACKING INSTRUCTIONS

1. Place the first Enclosure tray at the end of the box
2. Place the first Bear Statue tray at the end of the Enclosure tray
3. Place the Green Tile tray at the end of the box.



4. Place the second Enclosure tray on top of the first Enclosure tray
5. Place the second Bear Statue tray on top of the first Bear Statue tray
6. Place the first Animal House tray along the side of the box.
7. Place the remaining Bear Statue and Bonus display on the Green Tile tray.



8. Place the player boards on top of the exposed Enclosure tray.
9. Place the Bonus tiles tray next to the player boards above the Bear Statues.  
(Option: Player boards and Bonus tiles can be switched.)
10. Finally, place the remaining Animal House tray above the previous one.



## PACKING INSTRUCTIONS (continued)

11. Place the Park Area tiles on top of the Player boards.
12. Optional: Place the pre-cut piece of foam between the end of the Park Areas and the Bonus tiles tray



13. Place the board and the rulebook on top of the finished bed.
14. Place the box top on the package and you're done!

